

## Pump Performance Datasheet

|                      |                         |                       |
|----------------------|-------------------------|-----------------------|
| Customer :           | Quote Number / ID :     | 1471203               |
| Customer ref. / PO : | Model :                 | 60125 VL              |
| Tag Number : 001     | Stages :                | 1                     |
| Service :            | Based on curve number : | VL_60125_4P Rev Aug21 |
| Quantity : 1         | Basic model number :    | -                     |
|                      | Date last saved :       | 11/07/2023 5:18 PM    |

| Operating Conditions                            |                     | Liquid                          |                    |
|---|---------------------|---------------------------------|--------------------|
| Flow, rated                                     | : 924.2 USgpm       | Liquid type                     | : Cold Water       |
| Differential head / pressure, rated (requested) | : 51.77 ft          | Additional liquid description   | :                  |
| Differential head / pressure, rated (actual)    | : 51.94 ft          | Solids diameter, max            | : 0.00 in          |
| Suction pressure, rated / max                   | : 0.00 / 0.00 psi.g | Solids concentration, by volume | : 0.00 %           |
| NPSH available, rated                           | : Ample             | Temperature, max                | : 68.00 deg F      |
| Site Supply Frequency                           | : 60 Hz             | Fluid density, rated / max      | : 1.000 / 1.000 SG |

| Performance                |            | Material          |                    |
|----------------------------|------------|-------------------|--------------------|
| Speed, rated               | : 1780 rpm | Material selected | : Cast iron - 125# |
| Impeller diameter, rated   | : 8.25 in  |                   |                    |
| Impeller diameter, maximum | : 12.10 in |                   |                    |
| Impeller diameter, minimum | : 8.00 in  |                   |                    |

| Performance                            |                             | Pressure Data                      |               |
|--|-----------------------------|------------------------------------|---------------|
| Efficiency                             | : 68.03 %                   | Maximum working pressure           | : 28.13 psi.g |
| NPSH required / margin required        | : 9.56 / 0.00 ft            | Maximum allowable working pressure | : 175.0 psi.g |
| nq (imp. eye flow) / S (imp. eye flow) | : 32 / 184 Metric units     | Maximum allowable suction pressure | : 175.0 psi.g |
| MCSF                                   | : 266.1 USgpm               | Hydrostatic test pressure          | : 263.0 psi.g |
| Head, maximum, rated diameter          | : 65.00 ft                  |                                    |               |
| Head rise to shutoff                   | : 25.25 %                   |                                    |               |
| Flow, best eff. point                  | : 924.2 USgpm               |                                    |               |
| Flow ratio, rated / BEP                | : 100.00 %                  |                                    |               |
| Diameter ratio (rated / max)           | : 68.18 %                   |                                    |               |
| Head ratio (rated dia / max dia)       | : 35.97 %                   |                                    |               |
| Cq/Ch/Ce/Cn [ANSI/HI 9.6.7-2010]       | : 1.00 / 1.00 / 1.00 / 1.00 |                                    |               |
| Selection status                       | : Acceptable                |                                    |               |

| Energy Indexes |        | Driver & Power Data (@Max density) |                               |
|----------------|--------|------------------------------------|-------------------------------|
| PEI (CL)       | : 0.98 | Motor sizing specification         | : Max power (non-overloading) |
| ER (CL)        | : 2    | Margin over specification          | : 0.00 %                      |
|                |        | Service factor                     | : 1.00                        |
|                |        | Power, hydraulic                   | : 12.08 hp                    |
|                |        | Rated power (based on duty point)  | : 17.76 hp                    |
|                |        | Max power (non-overloading)        | : 19.88 hp                    |
|                |        | Nameplate motor rating             | : 20.00 hp / 14.91 kW         |

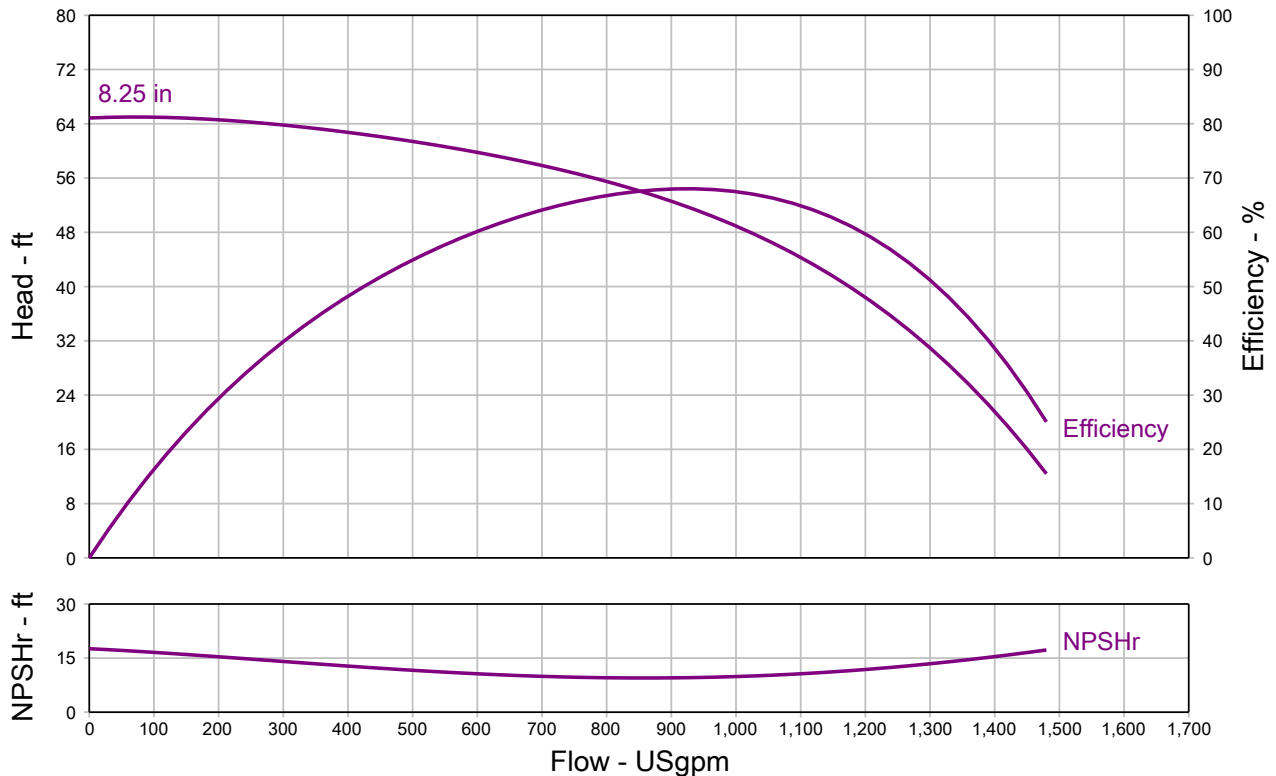

**Grundfos Series VL - In-Line Centrifugal Pump, Close Coupled**

|                                  |                     |                   |
|----------------------------------|---------------------|-------------------|
| <b>QUOTE NUMBER / ID</b> 1471203 | <b>UNIT TAG</b> 001 | <b>QUANTITY</b> 1 |
| <b>REPRESENTATIVE</b>            | <b>SERVICE</b>      | <b>DATE</b>       |
| <b>ENGINEER</b>                  | <b>SUBMITTED BY</b> | <b>DATE</b>       |
| <b>CONTRACTOR</b>                | <b>APPROVED BY</b>  | <b>DATE</b>       |
|                                  | <b>ORDER #</b>      | <b>DATE</b>       |



**VL 60125**  
**1780 rpm**

Part Number N/A

| Conditions of Service |             | Pump Data         |          | Motor Data |           |
|-----------------------|-------------|-------------------|----------|------------|-----------|
| Flow                  | 924.2 USgpm | Impeller Diameter | 8.24 in  | Motor HP   | 20 HP     |
| Head                  | 51.77 ft    | Max. Imp. Dia.    | 12.10 in | BHP        | 17.76 HP  |
| Liquid                | Cold Water  | Min. Imp. Dia.    | 8.00 in  | Enclosure  | TEFC      |
| Temperature           | 68.00 deg F | Efficiency        | 68.03 %  | Voltage    | 230/460 V |
| NPSHr                 | 9.56 ft     | Suction           | 6 in.    | Phase      | 3 Phase   |
| Viscosity             | 1.00 cP     | Discharge         | 6 in.    | Cycle      | 60        |
| Specific Gravity      | 1.000 SG    | PEI (CL)          | 0.98     | Frame Size | 256JM     |
|                       |             | ER (CL)           | 2        |            |           |

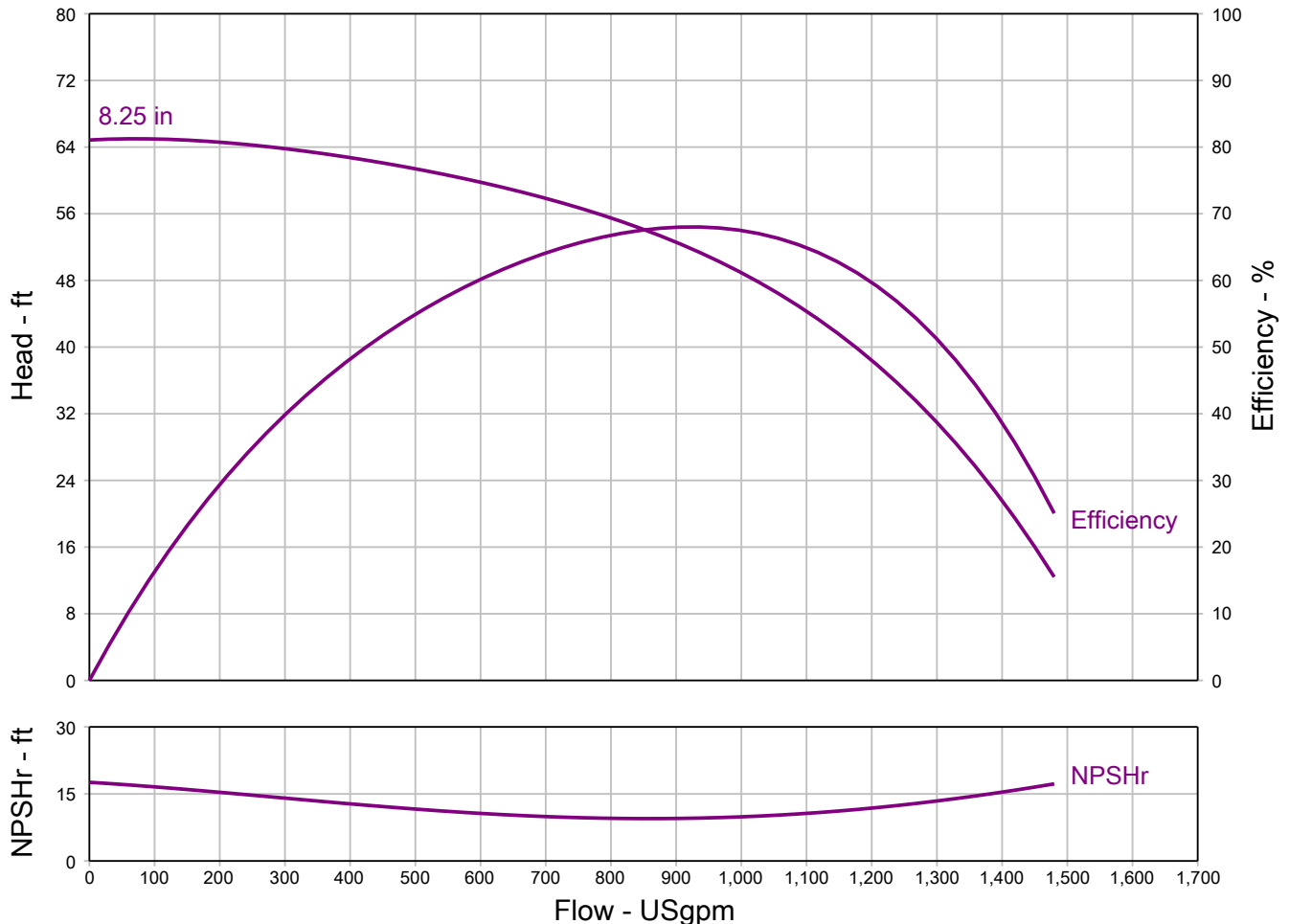

**Grundfos Series VL - In-Line Centrifugal Pump, Close Coupled**

Do not install pump larger than 215JM in vertical piping.

Pressure and drain tap locations are approximate.

Suction and discharge flanges, are cast per 250# ANSI thickness and diameter. All flanges are flat face. Some holes may be threaded because of nut clearances.

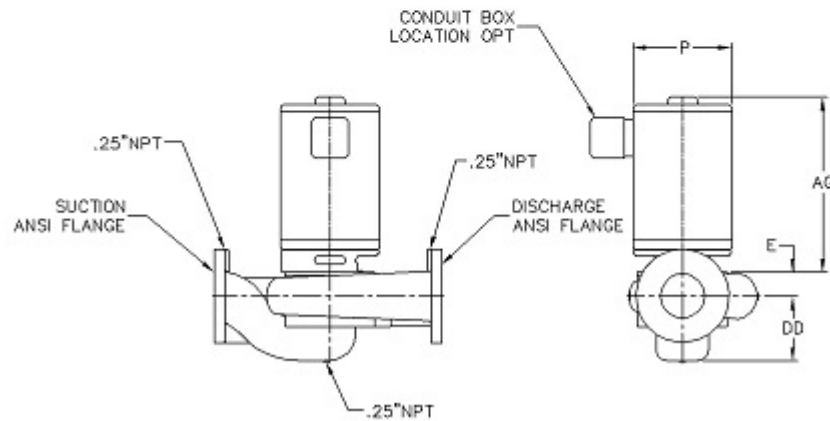
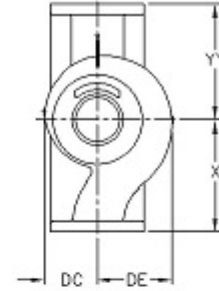

NOT FOR CONSTRUCTION, unless certified and referenced on order

| Units  | Frame | S x D | AG (Max) | DC   | DD    | DE    | E    | P (Max) | X     | YY    | Weight |
|--------|-------|-------|----------|------|-------|-------|------|---------|-------|-------|--------|
| inches | 256JM | 6 X 6 | 24.00    | 8.13 | 10.00 | 11.13 | 2.72 | 14.00   | 15.00 | 15.00 | TBD    |