

Pump Performance Datasheet

Customer :	Quote Number / ID :	1471203
Customer ref. / PO :	Model :	20959 VL
Tag Number : 001	Stages :	1
Service :	Based on curve number :	VL_20959_4P Rev 0
Quantity : 1	Basic model number :	-
	Date last saved :	11/06/2023 2:27 PM

Operating Conditions		Liquid	
Flow, rated	: 106.3 USgpm	Liquid type	: Cold Water
Differential head / pressure, rated (requested)	: 54.98 ft	Additional liquid description	:
Differential head / pressure, rated (actual)	: 55.20 ft	Solids diameter, max	: 0.00 in
Suction pressure, rated / max	: 0.00 / 0.00 psi.g	Solids concentration, by volume	: 0.00 %
NPSH available, rated	: Ample	Temperature, max	: 68.00 deg F
Site Supply Frequency	: 60 Hz	Fluid density, rated / max	: 1.000 / 1.000 SG
		Viscosity, rated	: 1.00 cP
		Vapor pressure, rated	: 0.34 psi.a

Performance		Material	
Speed, rated	: 1760 rpm	Material selected	: Cast iron - 125#
Impeller diameter, rated	: 7.70 in		
Impeller diameter, maximum	: 9.60 in		
Impeller diameter, minimum	: 7.00 in		
Efficiency	: 61.95 %		

Performance (cont.)		Pressure Data	
NPSH required / margin required	: 5.67 / 0.00 ft	Maximum working pressure	: 27.29 psi.g
nq (imp. eye flow) / S (imp. eye flow)	: 14 / 77 Metric units	Maximum allowable working pressure	: 175.0 psi.g
MCSF	: 29.51 USgpm	Maximum allowable suction pressure	: 175.0 psi.g
Head, maximum, rated diameter	: 63.05 ft	Hydrostatic test pressure	: 263.0 psi.g
Head rise to shutoff	: 13.28 %		
Flow, best eff. point	: 106.4 USgpm		
Flow ratio, rated / BEP	: 99.91 %		
Diameter ratio (rated / max)	: 80.21 %		
Head ratio (rated dia / max dia)	: 56.05 %		
Cq/Ch/Ce/Cn [ANSI/HI 9.6.7-2010]	: 1.00 / 1.00 / 1.00 / 1.00		
Selection status	: Acceptable		

Energy Indexes		Driver & Power Data (@Max density)	
PEI (CL)	: 0.90	Motor sizing specification	: Max power (non-overloading)
ER (CL)	: 10	Margin over specification	: 0.00 %
		Service factor	: 1.00
		Power, hydraulic	: 1.48 hp
		Rated power (based on duty point)	: 2.38 hp
		Max power (non-overloading)	: 2.97 hp
		Nameplate motor rating	: 3.00 hp / 2.24 kW

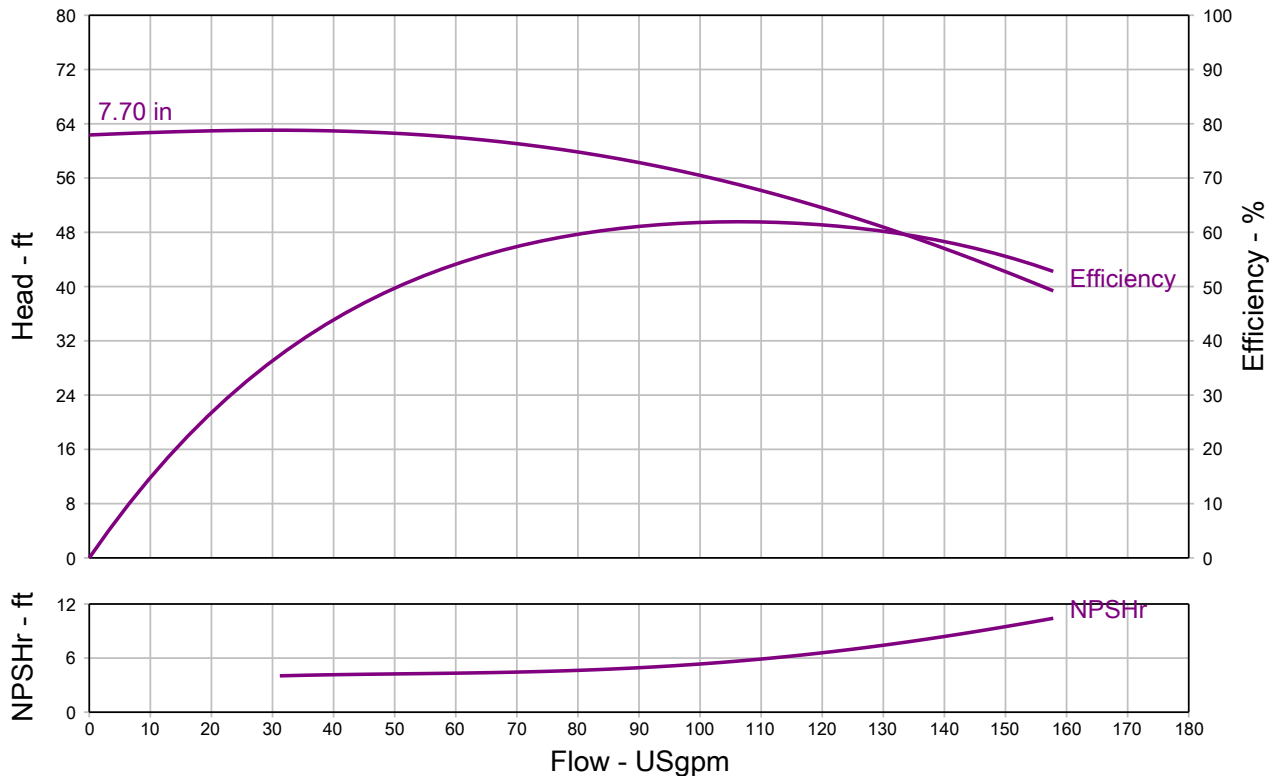

Grundfos Series VL - In-Line Centrifugal Pump, Close Coupled

QUOTE NUMBER / ID 1471203	UNIT TAG 001	QUANTITY 1
REPRESENTATIVE	SERVICE	
ENGINEER	SUBMITTED BY	DATE
CONTRACTOR	APPROVED BY	DATE
	ORDER #	DATE



VL 20959
1760 rpm

Part Number N/A

Conditions of Service		Pump Data		Motor Data	
Flow	106.3 USgpm	Impeller Diameter	7.69 in	Motor HP	3 HP
Head	54.98 ft	Max. Imp. Dia.	9.60 in	BHP	2.38 HP
Liquid	Cold Water	Min. Imp. Dia.	7.00 in	Enclosure	TEFC
Temperature	68.00 deg F	Efficiency	61.95 %	Voltage	230/460 V
NPSHr	5.67 ft	Suction	2 in.	Phase	3 Phase
Viscosity	1.00 cP	Discharge	2 in.	Cycle	60
Specific Gravity	1.000 SG	PEI (CL)	0.9	Frame Size	182JM
		ER (CL)	10		

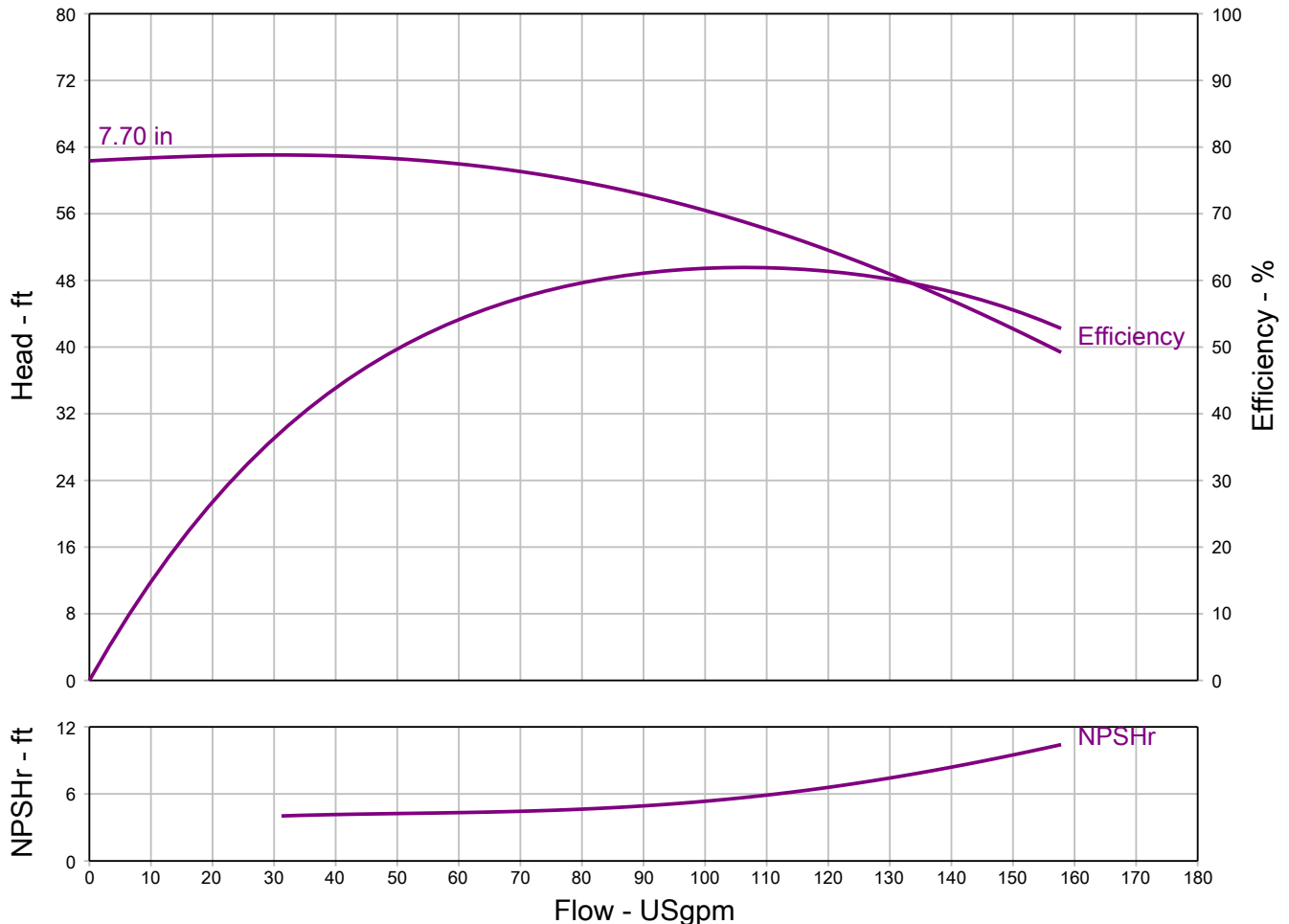

Grundfos Series VL - In-Line Centrifugal Pump, Close Coupled

Do not install pump larger than 215JM in vertical piping.

Pressure and drain tap locations are approximate.

Suction and discharge flanges, are cast per 250# ANSI thickness and diameter. All flanges are flat face. Some holes may be threaded because of nut clearances.

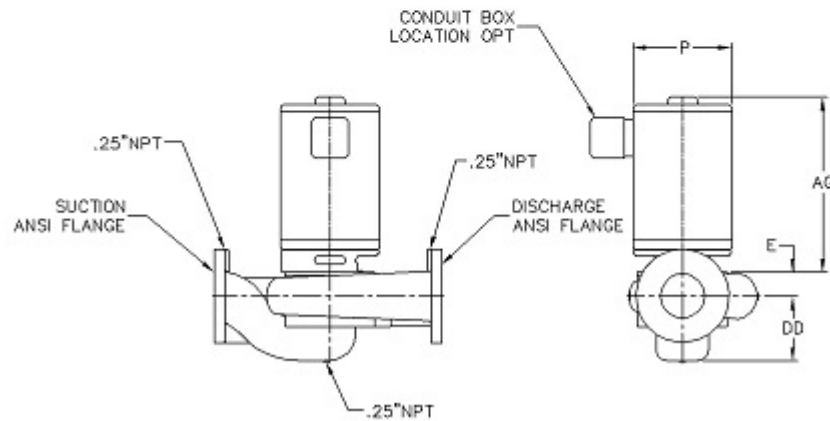
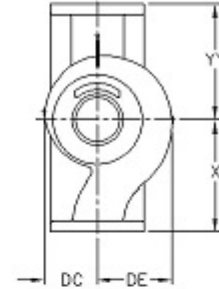

NOT FOR CONSTRUCTION, unless certified and referenced on order

Units	Frame	S x D	AG (Max)	DC	DD	DE	E	P (Max)	X	YY	Weight
inches	182JM	2 X 2	20.00	6.00	4.88	6.25	1.50	10.00	9.00	9.00	TBD