

## Pump Performance Datasheet

Customer :	Quote Number / ID :	1471203
Customer ref. / PO :	Model :	80123 VL
Tag Number : 001	Stages :	1
Service :	Based on curve number :	VL_80123_4P Rev Aug21
Quantity : 1	Basic model number :	-
	Date last saved :	11/07/2023 5:32 PM

Operating Conditions		Liquid	
Flow, rated	: 1,685.2 USgpm	Liquid type	: Cold Water
Differential head / pressure, rated (requested)	: 86.16 ft	Additional liquid description	:
Differential head / pressure, rated (actual)	: 86.16 ft	Solids diameter, max	: 0.00 in
Suction pressure, rated / max	: 0.00 / 0.00 psi.g	Solids concentration, by volume	: 0.00 %
NPSH available, rated	: Ample	Temperature, max	: 68.00 deg F
Site Supply Frequency	: 60 Hz	Fluid density, rated / max	: 1.000 / 1.000 SG
		Viscosity, rated	: 1.00 cP
		Vapor pressure, rated	: 0.34 psi.a
Performance		Material	
Speed, rated	: 1780 rpm	Material selected	: Cast iron - 125#
Impeller diameter, rated	: 10.17 in	Pressure Data	
Impeller diameter, maximum	: 12.10 in	Maximum working pressure	: 43.47 psi.g
Impeller diameter, minimum	: 7.80 in	Maximum allowable working pressure	: 175.0 psi.g
Efficiency	: 82.17 %	Maximum allowable suction pressure	: 175.0 psi.g
NPSH required / margin required	: 19.05 / 0.00 ft	Hydrostatic test pressure	: 263.0 psi.g
nq (imp. eye flow) / S (imp. eye flow)	: 38 / 158 Metric units	Driver & Power Data (@Max density)	
MCSF	: 478.3 USgpm	Motor sizing specification	: Max power (non-overloading)
Head, maximum, rated diameter	: 100.5 ft	Margin over specification	: 0.00 %
Head rise to shutoff	: 16.58 %	Service factor	: 1.00
Flow, best eff. point	: 1,685.2 USgpm	Power, hydraulic	: 36.66 hp
Flow ratio, rated / BEP	: 100.00 %	Rated power (based on duty point)	: 44.61 hp
Diameter ratio (rated / max)	: 84.05 %	Max power (non-overloading)	: 49.93 hp
Head ratio (rated dia / max dia)	: 59.99 %	Nameplate motor rating	: 50.00 hp / 37.29 kW
Cq/Ch/Ce/Cn [ANSI/HI 9.6.7-2010]	: 1.00 / 1.00 / 1.00 / 1.00		
Selection status	: Acceptable		
Energy Indexes			
PEI (CL)	: 1.00		
ER (CL)	: 0		

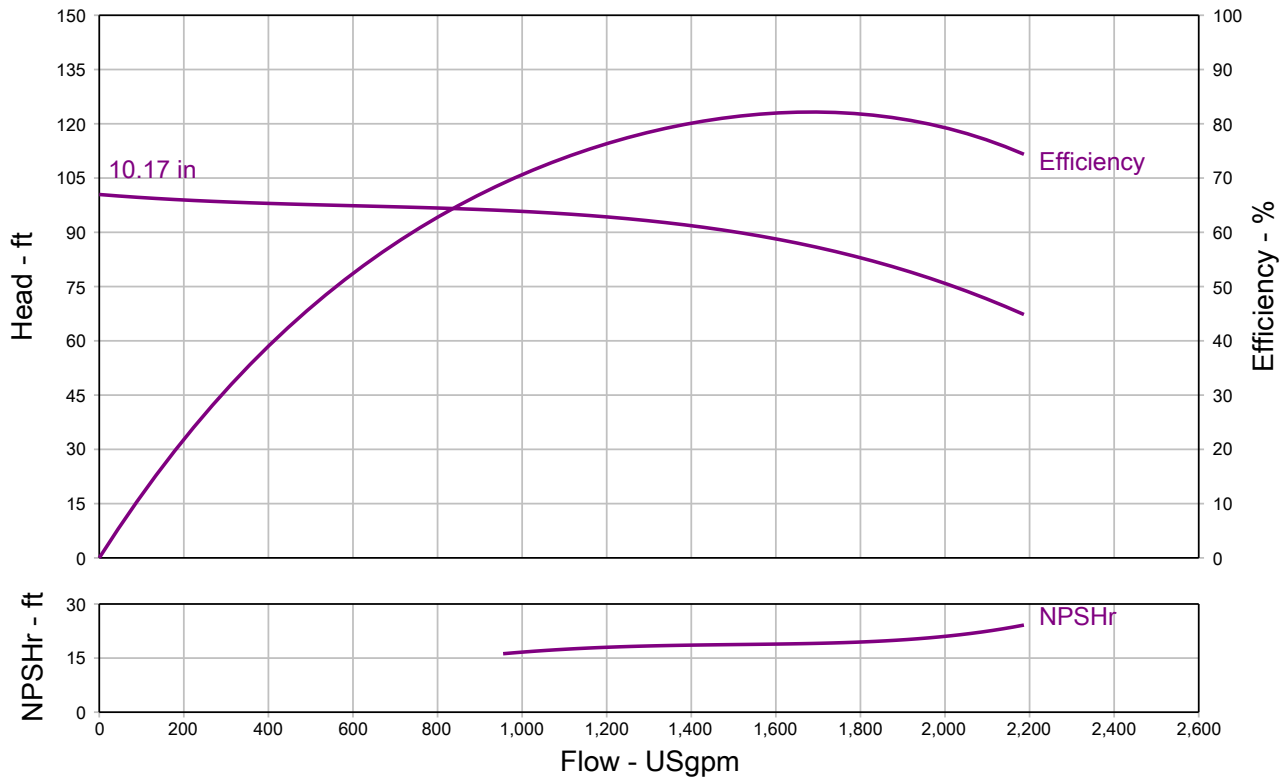

**Grundfos Series VL - In-Line Centrifugal Pump, Close Coupled**

<b>QUOTE NUMBER / ID</b> 1471203	<b>UNIT TAG</b> 001	<b>QUANTITY</b> 1
<b>REPRESENTATIVE</b>	<b>SERVICE</b>	
<b>ENGINEER</b>	<b>SUBMITTED BY</b>	<b>DATE</b>
<b>CONTRACTOR</b>	<b>APPROVED BY</b>	<b>DATE</b>
	<b>ORDER #</b>	<b>DATE</b>



**VL 80123**  
**1780 rpm**

Part Number N/A

Conditions of Service		Pump Data		Motor Data	
Flow	1,685.2 USgpm	Impeller Diameter	10.17 in	Motor HP	50 HP
Head	86.16 ft	Max. Imp. Dia.	12.10 in	BHP	44.61 HP
Liquid	Cold Water	Min. Imp. Dia.	7.80 in	Enclosure	TEFC
Temperature	68.00 deg F	Efficiency	82.17 %	Voltage	230/460 V
NPSHr	19.05 ft	Suction	8 in.	Phase	3 Phase
Viscosity	1.00 cP	Discharge	8 in.	Cycle	60
Specific Gravity	1.000 SG	PEI (CL)	1	Frame Size	326JM
		ER (CL)	0		

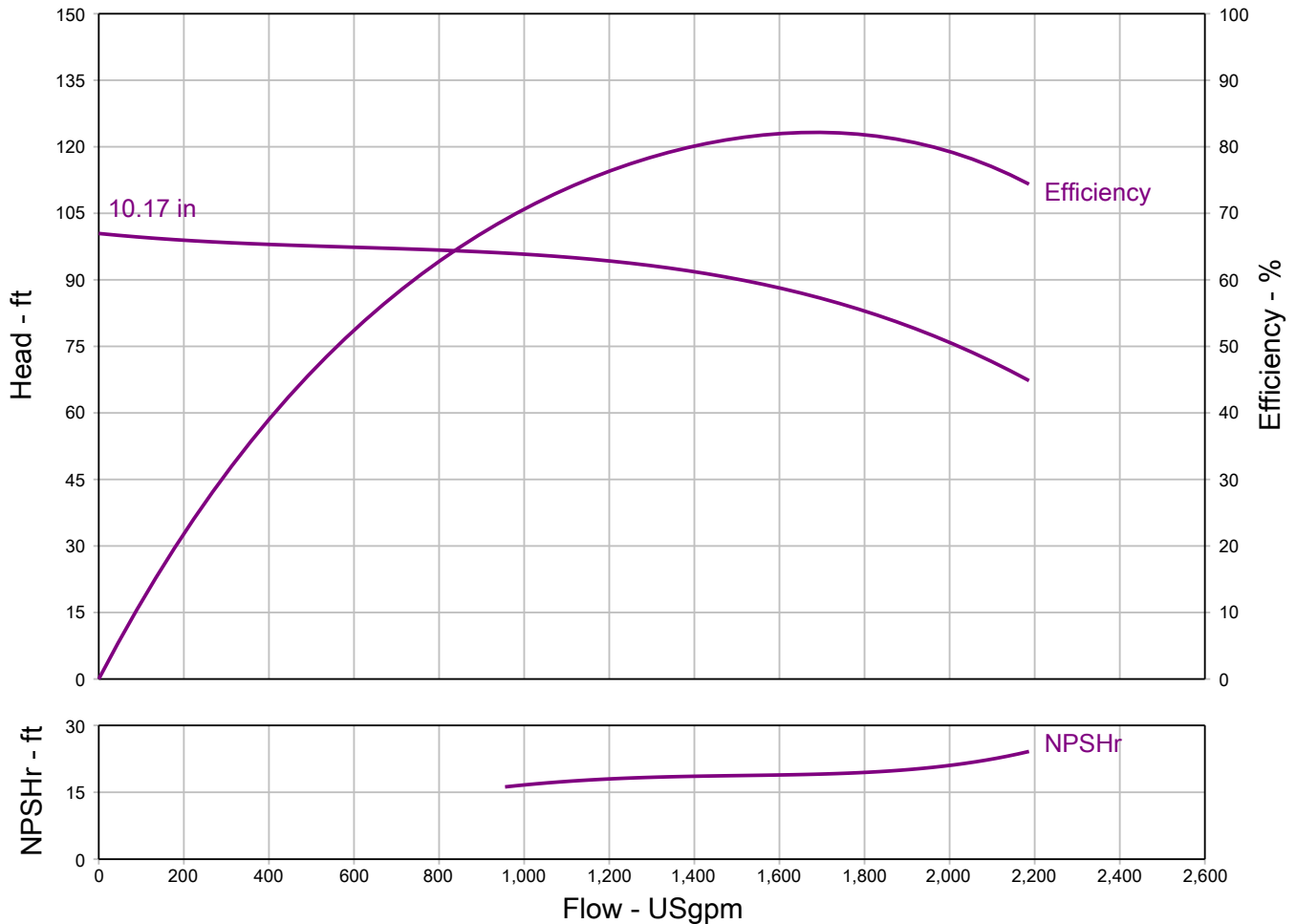

**Grundfos Series VL - In-Line Centrifugal Pump, Close Coupled**

Do not install pump larger than 215JM in vertical piping.

Pressure and drain tap locations are approximate.

Suction and discharge flanges, are cast per 250# ANSI thickness and diameter. All flanges are flat face. Some holes may be threaded because of nut clearances.

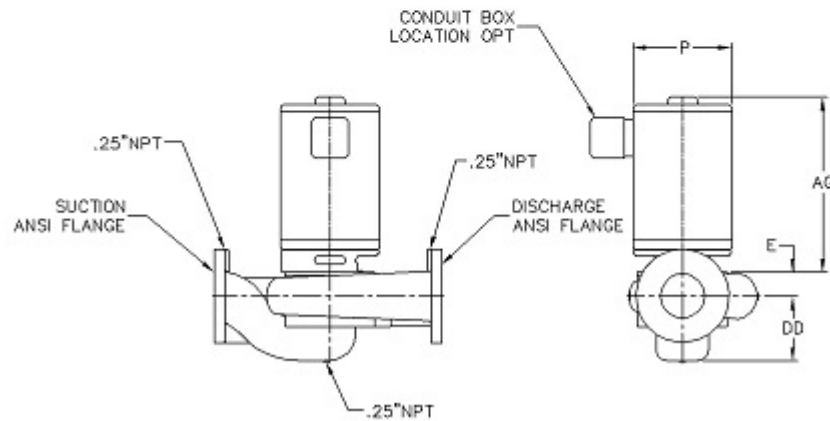
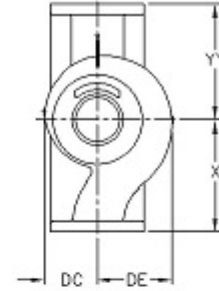

NOT FOR CONSTRUCTION, unless certified and referenced on order

Units	Frame	S x D	AG (Max)	DC	DD	DE	E	P (Max)	X	YY	Weight
inches	326JM	8 X 8	30.00	8.75	12.00	12.75	2.88	17.00	19.00	19.00	TBD