

PROJECT:	UNIT TAG:	QUANTITY:
REPRESENTATIVE:	TYPE OF SERVICE:	
ENGINEER:	SUBMITTED BY:	DATE:
CONTRACTOR:	APPROVED BY:	DATE:
	ORDER NO.:	DATE:



ALPHA2 26-99F

ALPHA2 26-99 is a high-efficiency circulator designed for heating and cooling applications. It features different operating modes, including constant pressure AUTOADAPT and proportional pressure AUTOADAPT.

Note! Product picture may differ from actual product

Conditions of Service		Pump Data		Motor Data	
Liquid:	Water	Maximum operating pressure:	145.04 psi	P1 max:	3 .. 120 W
Temperature:	140 °F	Liquid temperature range:	14 .. 203 °F	Rated voltage:	115 V
Specific Gravity:	0.985	Maximum ambient temperature:	131 °F	Mains frequency:	60 Hz
		Approvals:	UL	Enclosure class:	IP42
		Pipe connection:	1 1/4	Insulation class:	F
		Product number:	99490916	Motor protection:	NONE
				Thermal protection:	ELEC

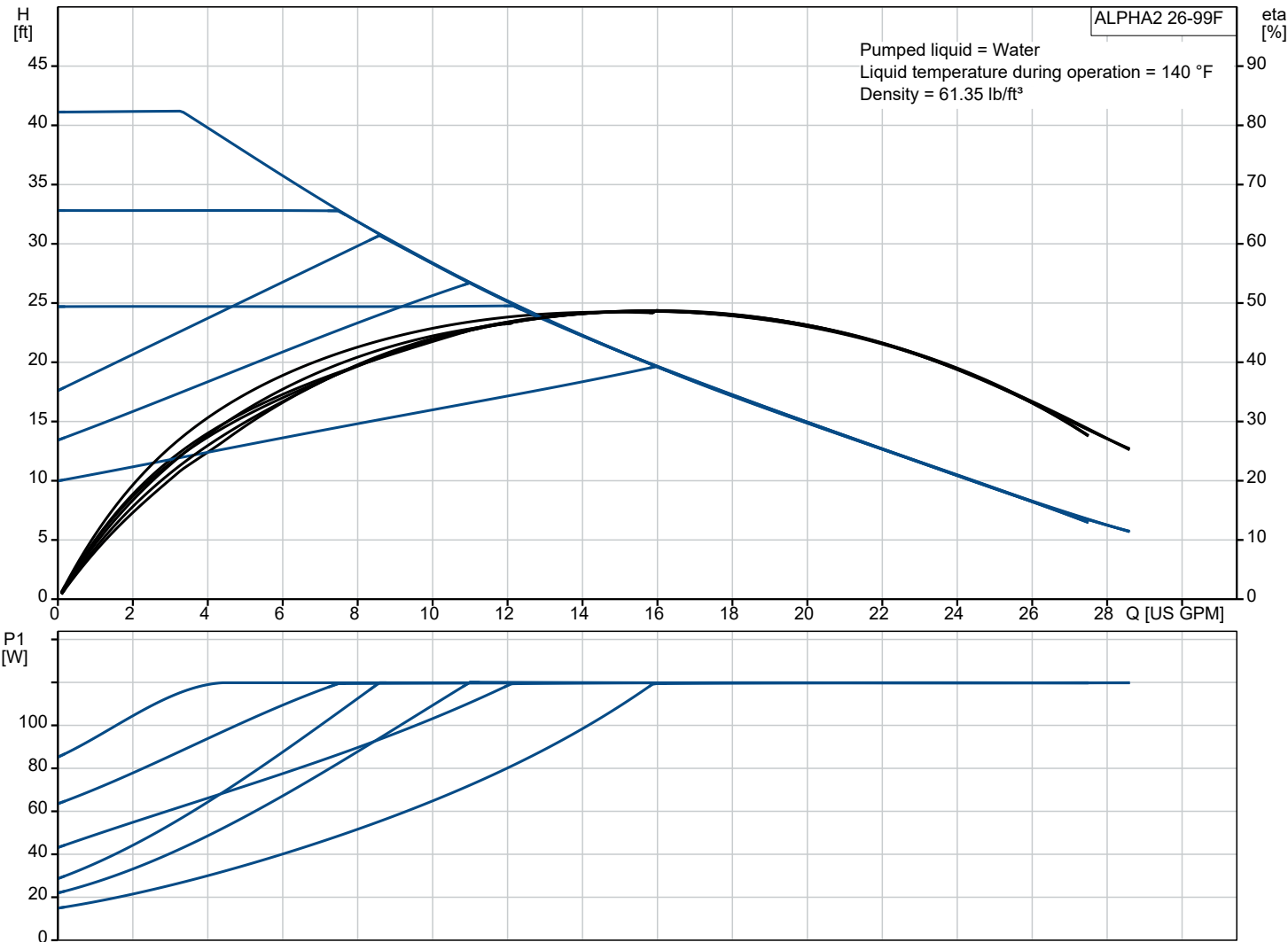

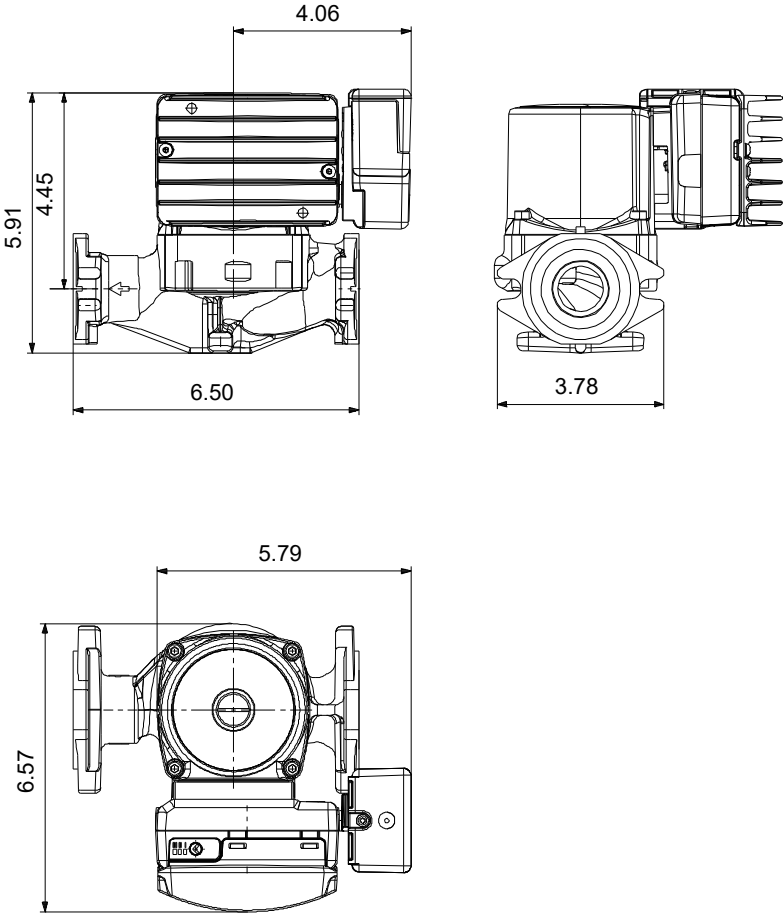

Materials:
Pump housing: Cast iron
Pump housing: EN 1561 EN-GJL-150
Impeller: Composite

Description	Value
General information:	
Product name:	ALPHA2 26-99F
Product No:	99490916
EAN number:	5713829959309
Technical:	
Head max:	32.48 ft
TF class:	110
Approvals on nameplate:	UL
Materials:	
Pump housing:	Cast iron
Pump housing:	EN 1561 EN-GJL-150
Impeller:	Composite
Installation:	
Range of ambient temperature:	32 .. 131 °F
Maximum operating pressure:	145.04 psi
Type of connection:	GF
Pipe connection:	1 1/4
Pressure rating:	PN 10
Port-to-port length:	6 1/2 in
Liquid:	
Pumped liquid:	Water
Liquid temperature range:	14 .. 203 °F
Selected liquid temperature:	140 °F
Density:	61.35 lb/ft³
Electrical data:	
Power input - P1:	3 .. 120 W
Mains frequency:	60 Hz
Rated voltage:	1 x 115 V
Maximum current consumption:	0.05 .. 1.7 A
Enclosure class (IEC 34-5):	IP42
Insulation class (IEC 85):	F
Built-in motor protection:	NONE
Thermal protec:	ELEC
Controls:	
Pos term box:	6H
Others:	
Net weight:	7.71 lb
Gross weight:	8.47 lb
Shipping volume:	0.28 ft³
Sales region:	USA

