

GENERAL NOTES

- ① - PUMP CAN BE INSTALLED FREE STANDING OR WITH AUTO-COUPLING SYSTEM. DRAWING SHOWN USES GRUNDFOS COORDINATED AUTO-COUPLING WITH ANSI CONNECTION TO PUMP AND NPT PIPE CONNECTION, AVAILABLE TO BE INCLUDED WITH PUMP (I&O 3.1).
- ② - WHEN USING AN AUTO-COUPLING ATTACH LIFTING CHAIN TO SMALL LOOP, IF FREE STANDING USE THE LARGER LOOP (I&O 4.3). LIFT CHAIN AVAILABLE WITH MAX WEIGHT OF 705 LBS (320 KG).
- ③ - PUMP MINIMUM OPERATING LEVEL FOR INTERMITTENT USAGE (I&O 10.2). WHEN USING INTERMITTENT OPERATION MAXIMUM STARTS PER HOUR IS 30 (I&O 3.3).
- ④ - PUMP MINIMUM OPERATING LEVEL FOR CONTINUOUS USAGE (I&O 10.2).
- ⑤ - IT IS RECOMMENDED TO INCLUDE AN EMERGENCY SHUT OFF AND START UP SENSOR SEPARATE FROM STANDARD LEVEL CONTROLS (I&O 9.2).
- ⑥ - FULL DUPLEX SYSTEM EXAMPLE, ENLARGED VIEW TO SHOW PUMP INFORMATION. FULL SYSTEM DETAILS AVAILABLE UPON REQUEST.
- ⑦ - POWER CABLE TYPE 7G AWG16, STANDARD SIZE IS 33 FT LONG.

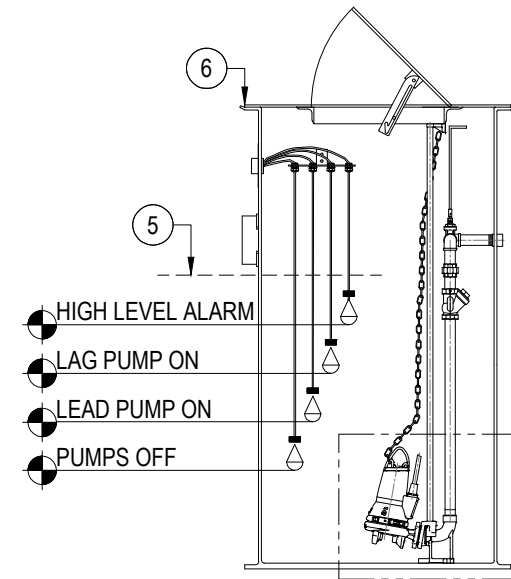
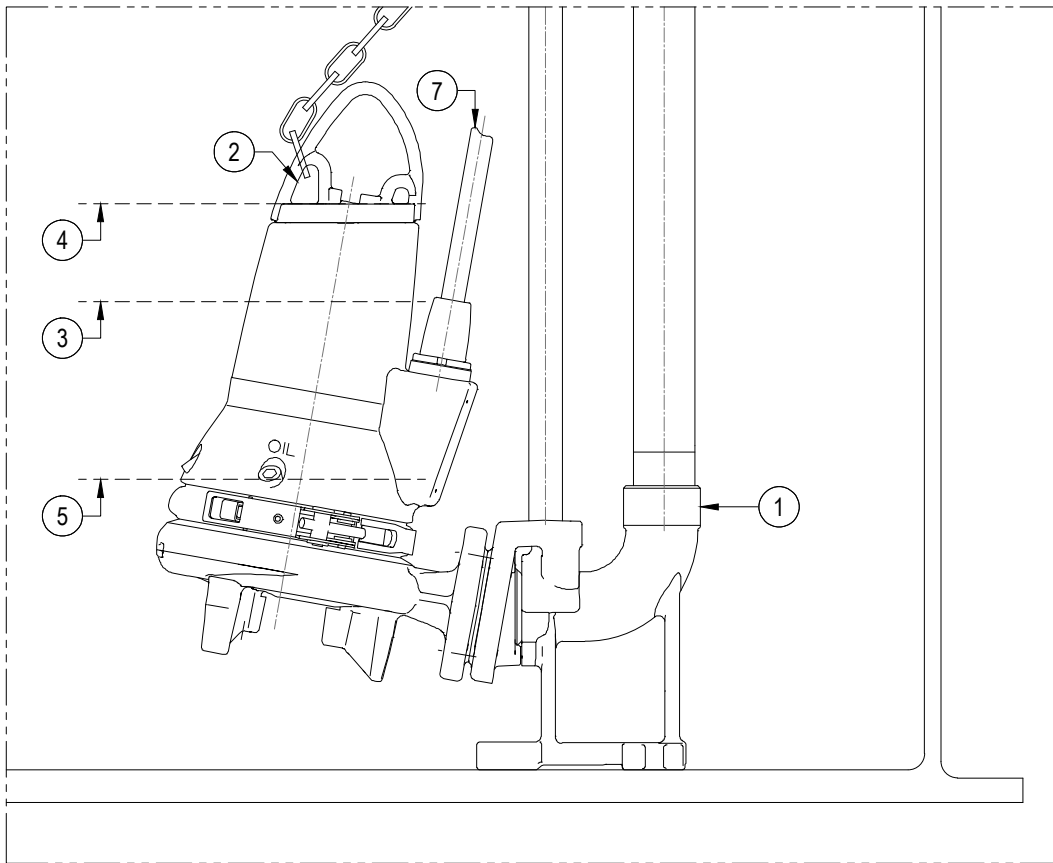

1

ELEVATION VIEW WITH DETAILS

SCALE: NTS



DRAWING TITLE:
GRUNDFOS SEG GRINDER SUMP PUMP DETAIL
FOR ENGINEERING DOCUMENTS

DRAWING NUMBER:
015

DRAWN BY
BM

LAST REVISED
08/31/2022

DRAWING SCALE
NTS

THE DOCUMENT AND ALL INFORMATION SHOWN IS PROPERTY OF HURLEY ENGINEERING, INC. THIS DOCUMENT IS NOT TO BE REDISTRIBUTED OR COPIED OR USED FOR THE MANUFACTURING OF EQUIPMENT WITHOUT PRIOR WRITTEN CONSENT FROM HURLEY ENGINEERING, INC.

QR CODE

